



THERMO KING

TriPac EVOLUTION™ 50 Amp In-Line Fuse Kit Installation Procedures

KIT 401331



WARNING: Before beginning this procedure, turn APU OFF at the HMI Controller and then remove the APU main power fuse from the holder in the battery box.

Maxi-Fuse Removal Procedures

1. Remove APU top and bottom covers.
2. Remove power lead from alternator output (**B+**) terminal.
3. Remove hardware securing 50 amp fuse holder to APU frame. Retain washer and nut for reuse later.
4. Remove entire 50 amp fuse holder from main harness by cutting the lead 2.00 in. (51mm) after the factory splice connection. Discard the entire fuse assembly. **NOTE: The existing rear panel band tie and main harness anchor points will be re-used for installation of new fuse holder harness.**

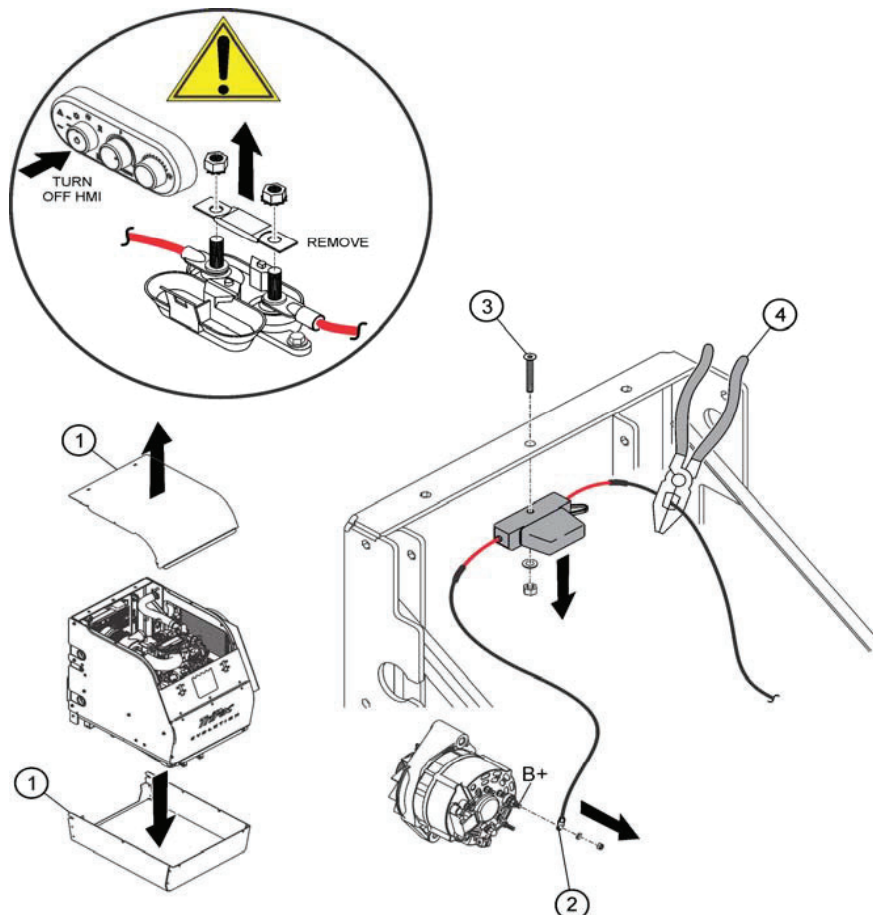

RCS293

New In-Line Fuse Installation Procedures

5. Remove a 2.00 in. (51mm) section of harness braiding and strip 0.50 in. (12mm) from end of the 8 gauge harness wire.
6. Slide supplied heat shrink tubing onto fuse wire and position it away from connection.
7. Use supplied butt splice connector and securely crimp the two 8 gauge wires together.
8. Position heat shrink tubing over entire connection and then apply heat.
9. Wrap electrical tape around end of braiding near butt splice to prevent fraying.
10. Attach supplied mounting bracket to APU frame with hardware removed in step 3 and new 20mm bolt.
11. Insert the two supplied cable tie mounts into holes in fuse bracket as shown.
12. Secure new in-line fuse onto bracket with tie bands making sure tubing slopes downward and re-anchor harness lengths to existing anchor points that the previous fuse holder harness utilized in step 4.
13. Route power lead with terminal ring to alternator output (**B+**) terminal and attach with hardware removed earlier. Tighten hardware to 48.5 +/- 4.5 in-lbs
14. Reinstall APU covers removed in prior steps and the TriPac main power fuse to tractor's positive (+) battery connection.

